

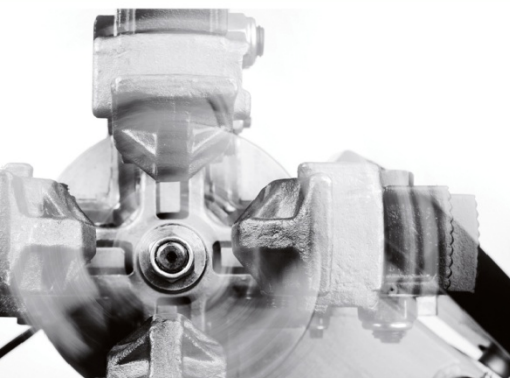

**ATH-Heinl**

# OPERATING INSTRUCTIONS

**ATH      Bike-Lift 7F**  
**ATH      Bike-Lift 7FQ**

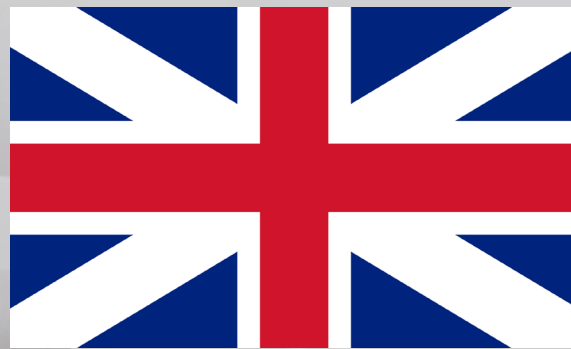

4500 kg



## Contents

1.0	INTRODUCTION .....	- 3 -
1.1	General Information.....	- 3 -
1.2	Description.....	- 4 -
1.3	Operation.....	- 5 -
1.4	Technical Data .....	- 11 -
1.5	Scale Drawing .....	- 12 -
2.0	INSTALLATION .....	- 13 -
2.1	Transport & Storage Conditions .....	- 13 -
2.2	Unpacking the machine.....	- 15 -
2.3	Delivery Contents .....	- 16 -
2.4	Location.....	- 17 -
2.5	Fixing .....	- 19 -
2.6	Electrical Connection.....	- 19 -
2.7	Pneumatic Connection.....	- 19 -
2.8	Hydraulic Connection .....	- 20 -
2.9	Assembly .....	- 21 -
2.10	Completion of Work.....	- 24 -
3.0	OPERATION .....	- 25 -
3.1	Operating Instructions .....	- 25 -
3.2	Basic Information .....	- 26 -
4.0	MAINTENANCE .....	- 27 -
4.1	Consumables for installation, maintenance and servicing.....	- 27 -
4.2	Safety Regulations for Oil .....	- 28 -
4.3	Notes .....	- 29 -
4.4	Maintenance or Service Plan .....	- 29 -
4.5	Troubleshooting / Error Display and Solutions .....	- 30 -
4.6	Maintenance and Service Instructions.....	- 32 -
4.7	Disposal.....	- 33 -
5.0	EG-/EU-KONFORMITÄTSERKLÄRUNG / EC-/EU-DECLARATION OF CONFORMITY.....	- 34 -
6.0	APPENDIX .....	- 34 -
6.1	Pneumatic circuit diagram .....	- 35 -
6.2	Electric circuit diagram.....	- 36 -
6.3	Hydraulic circuit diagram.....	- 37 -
7.0	WARRANTY CARD.....	- 38 -
7.1	Scope of the Product Warranty .....	- 39 -
8.0	INSPECTION LOG .....	- 40 -
8.1	Installation and Handover Log .....	- 41 -
8.2	Inspection Plan.....	- 42 -
8.3	Visual inspection (authorised expert).....	- 43 -
9.0	NOTES.....	- 47 -

## 1.0 INTRODUCTION

### 1.1 General Information

	<p><b>THESE INSTRUCTIONS ARE AN INTEGRAL PART OF THE MACHINE. THEY MUST BE READ AND UNDERSTOOD BY THE USER. NO LIABILITY IS ASSUMED FOR ANY DAMAGES CAUSED BY FAILURE TO FOLLOW THESE INSTRUCTIONS OR THE VALID SECURITY PROVISIONS.</b></p>
---	--

	<p>WARNING: Follow the instructions to prevent injury or damage.</p>
	<p>TIP: Provides more information on functionality and tips for using the device efficiently.</p>

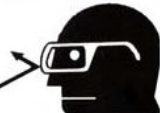
	<p>Appropriate protective clothing must be worn for all work on the described system.</p>
--	---

## 1.2 Description

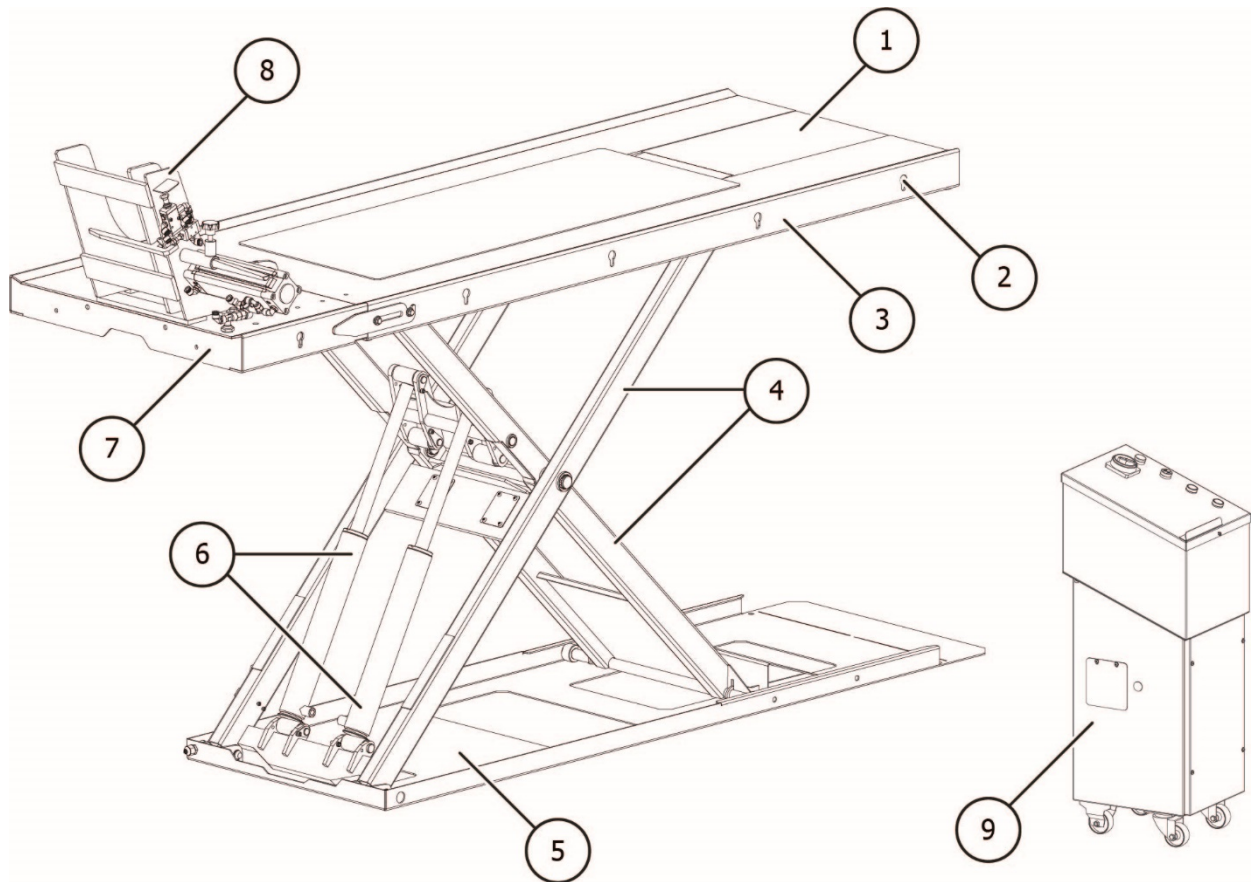

①	Foldable rear wheel recess
②	The motorcycle can be secured on the holes of the lift platform by straps.
③	Lifting Platform The platform is moved upwards with internal hydraulic cylinders and the scissors principle. The hydraulic safety device prevents the lift lowering unintentionally.
④	Scissor pair
⑤	Base frame
⑥	Hydraulic cylinders
⑦	Foldable front extension
⑧	Wheel clamping device
⑨	Hydraulic Power unit with control Box (dead-man System) The hydraulic oil in the tank is fed to the cylinders via a gear pump driven by the motor. A lowering valve returns the oil to the oil tank.

### 1.3 Operation

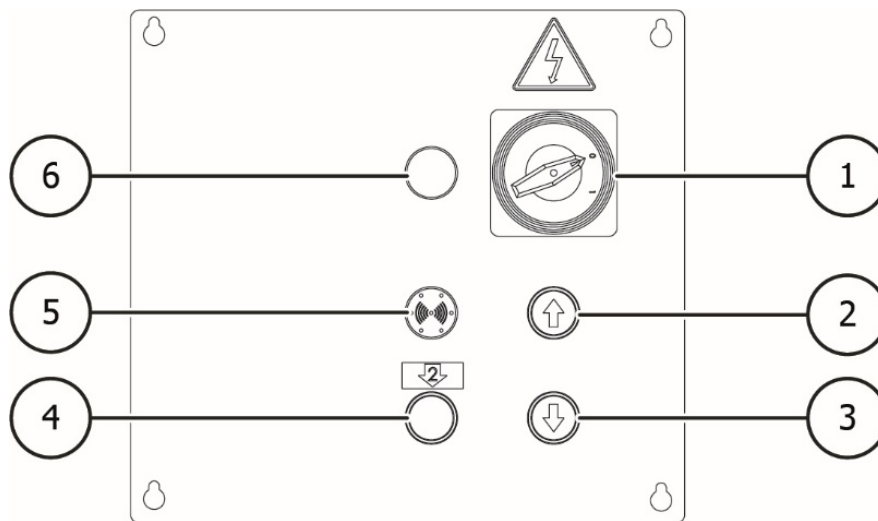

①	Lockable main switch with emergency stop function to switch the lifting platform on and off and to prevent operation by unauthorised persons.
②	Lifting push button raises the lifting platform
③	The lowering push button lowers the lifting platform
④	The lowering push button To lower the lift after the CE-stop is activated which it stops the platform when it is moving downwards at a height of 500mm.
⑤	Alarm gives an acoustic and visual signal when the CE stop is reached
⑥	Signal lamp indicates whether that the lift is in stand-by.

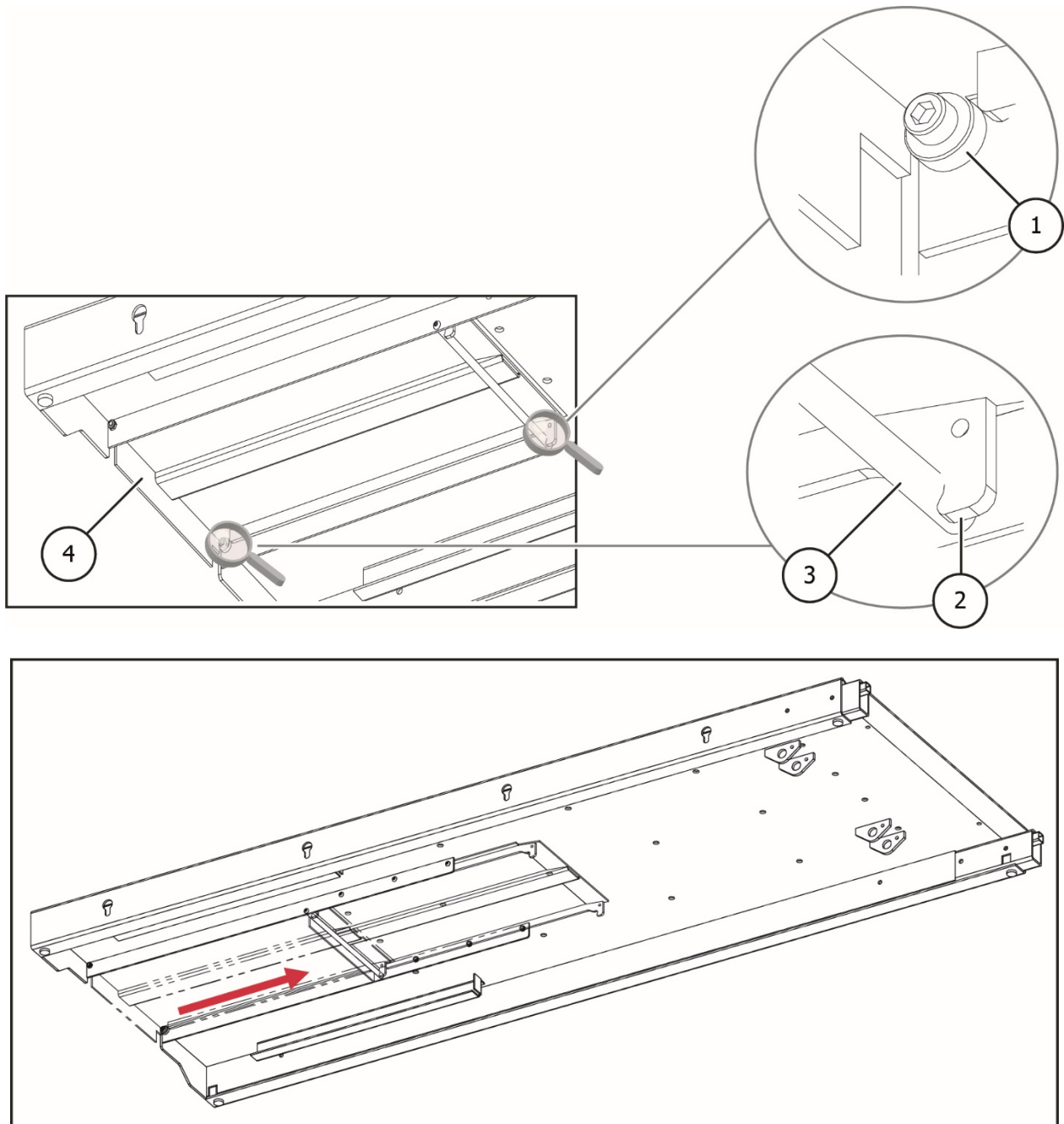

### Foldable rear wheel recess

Originally the cover plate (4) is secured by the stop roller (1) in the rear and by the hook (2) in the middle. To push the ramp into the platform, please pull up the ramp by hand so that it can go pass the stop roller (1) then push it under the main platform until it is stopped by the shaft (3).

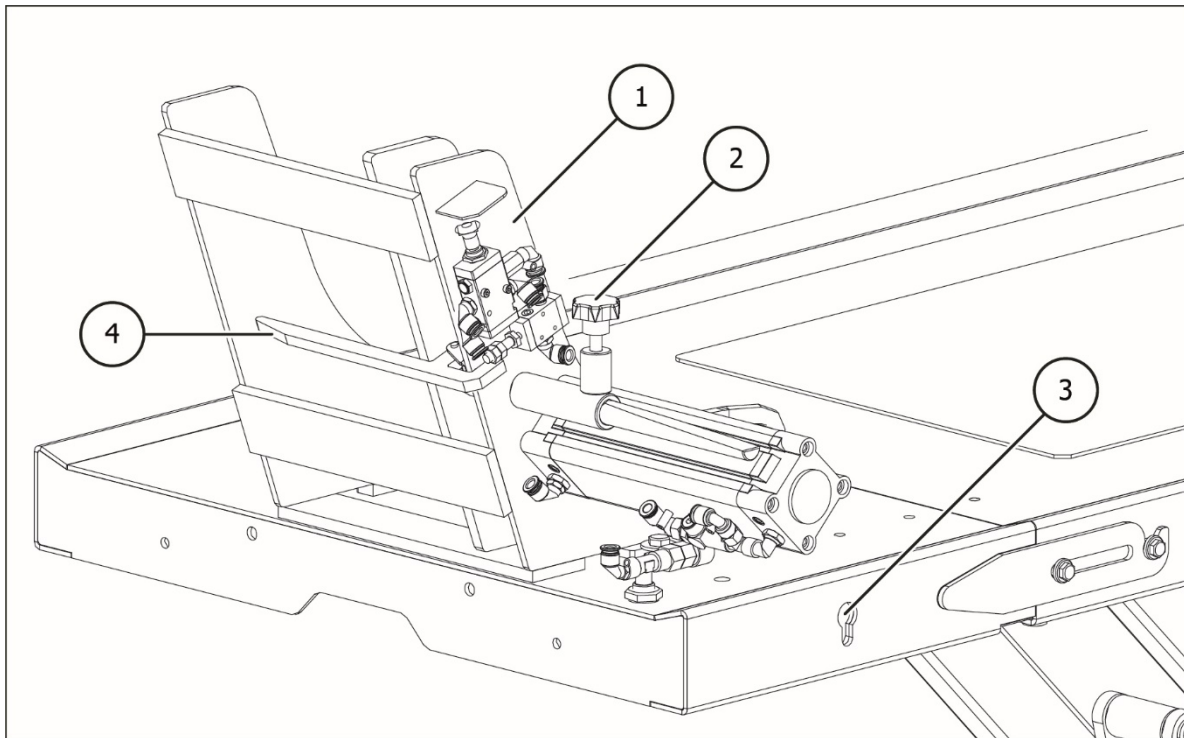

## Pneumatic wheel clamping

1. Position the front wheel between the clamping device ①.
2. Drive the motorcycle on the lift until the front wheel it actuates the wheel clamping device by pressing the lever ④.  
Now the pneumatic cylinders begin to press the clamping plate against the wheel and thereby tension it.  
Before getting off, check again whether the motorcycle has been securely locked and fold the side or main stand down.
3. For safety purpose, this clamping device can be locked by turning the handwheel-screw ② in clockwise direction in case of the air failure.
4. The motorcycle must be fastened with straps to the holes ③ on the platforms of the lift.

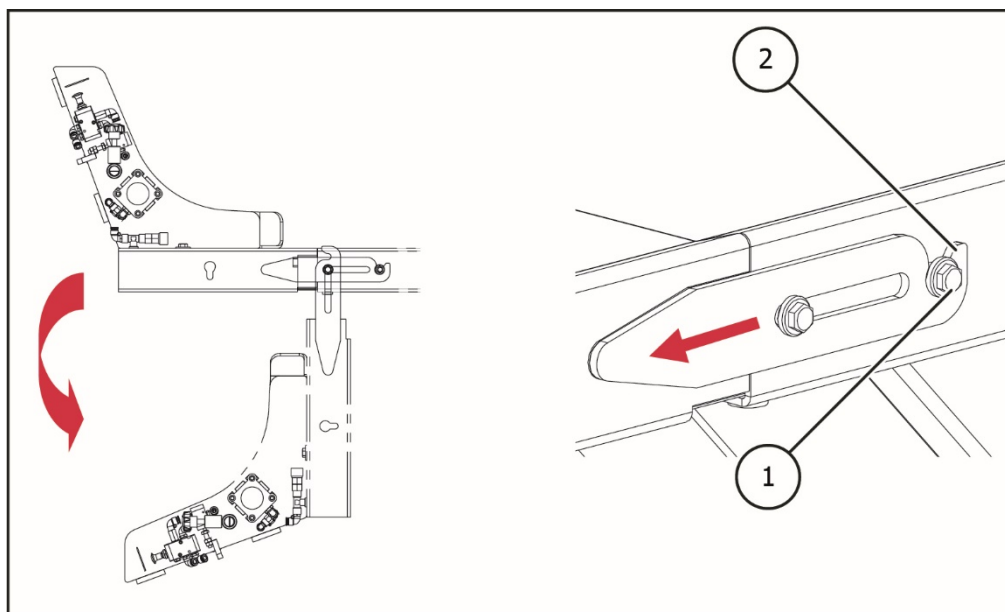

### Foldable front extension

To make working with the front wheel easier, the platform front extension can be folded under the platform with the clamping device when the lift is fully raised.

To fold the platform front extension, loosen screw (1) a little so that hook (2) can be lifted out of the screws.

To rotate, pull the front extension forward as shown.



## Safety instructions

1. Ensure there is correct weight distribution of the vehicle
2. Changes to the lift of any kind are not permitted
3. Leave the danger zone when lowering the lift
4. No objects or persons may be transported on the lift, the two guide rails or on the vehicle that is being lifted.
5. If there is a danger of the vehicle falling, you must leave the danger zone immediately
6. Prevent the lifted vehicle from swaying significantly
7. The lift may only be operated by trained personnel.
8. Use suitable slings to secure the vehicle against falling
9. Only authorised persons are allowed to enter the danger zone.
10. Proper maintenance and inspections are necessary for safe work
11. Read and understand the operating instructions before operating the lift
12. Do not work on damaged lifts
13. Keep the shearing points free when moving the lift
14. Do not clean the lift under running water.
15. Use suitable roll protection

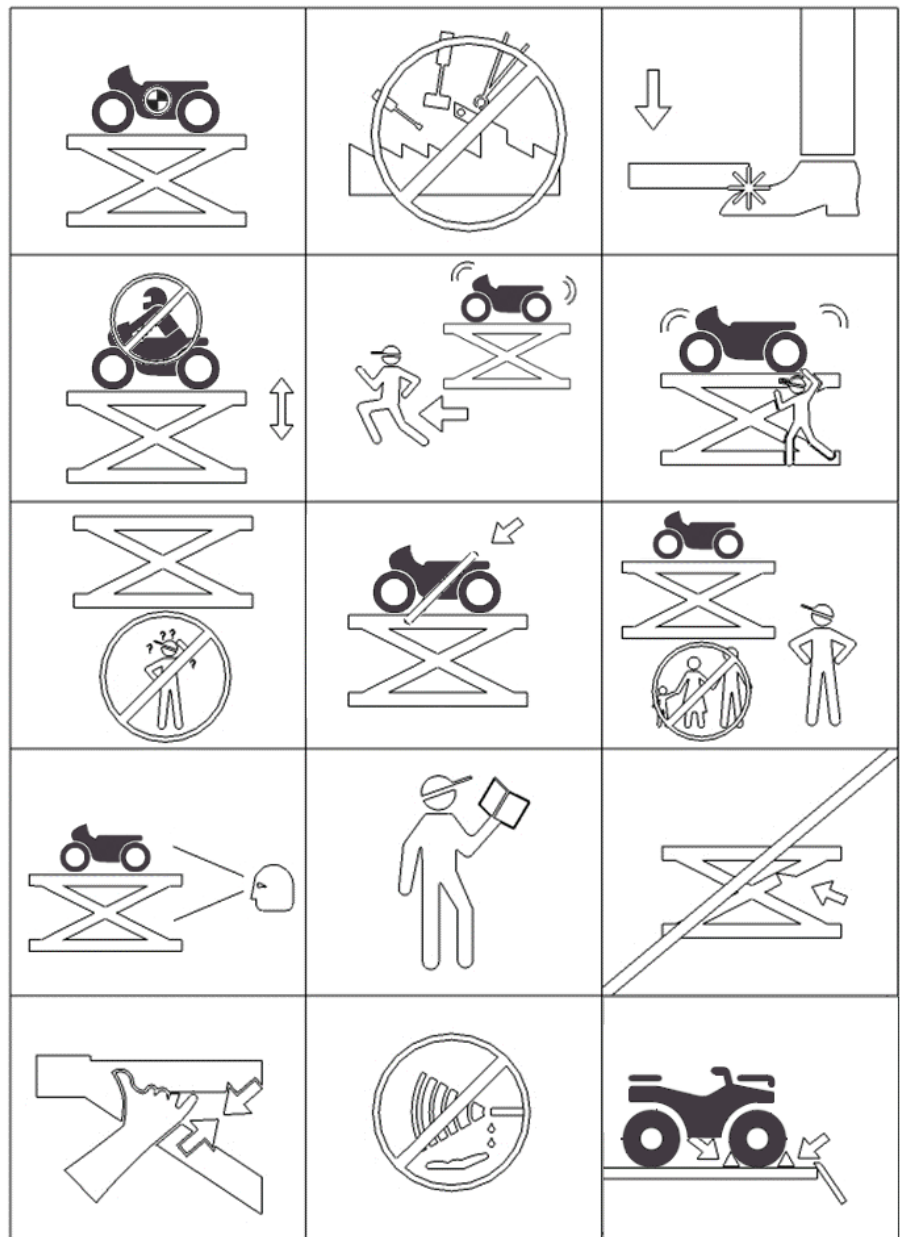

## Usage

The product is intended for lifting vehicles. The relevant technical data of the lift must be observed.

### 1. Preparation

- a.  Carefully read all the safety instructions before operating the lift.
- b. Check the ground clearance of the vehicle to ensure that no parts come into contact with the platform when it is being placed.
- c. Place the vehicle in the middle of the lift. Pay attention to the load distribution.
- d. Fix the vehicle on the platform. Appropriate wheel clamps or tension belts are to be used for this.

### 2. Lifting

- a. Switch on the lift using the main switch.
- b. Raise the vehicle to a height of 100-150mm and stop lifting by releasing the lift button.
- c. Check whether the vehicle is safely on the lift.
- d. Then continue to lift and observe the lifting process.

### 3. Lowering

- a. Before lowering, check whether there are any objects under the vehicle or the lift.
- b. Press the lower button, the lift lowers completely.

### 4. Driving Out

- a. Remove the fixings and secure the vehicle against tipping over.
- b. Drive out the vehicle.

## 1.4 Technical Data

Capacity	700 kg
Lifting height	80– 1200 mm
Lifting / lowering time	23 s
Motor	1, kW
Electrical system	1 X 230V/50Hz
Control voltage	DC24V
Fuse Protection	3 C 16 A
Supply line	Min. 3x 1,5mm <sup>2</sup>
Protection class	IP 54
Hydraulic pressure <sup>2</sup>	160 bar
Recommended hydraulic oil	Summer: H-LPD 32 (z.B.: OEST H-LPD 32 DD L) Winter: H-LPD 22
Oil quantity	Ca. 6 l
Floor anchoring	Chemical anchor: M8x100
Anchors quantity	6 X
Noise level	≤ 70 dB
packaging	2200 x 800 x 800 mm
Weight	345 kg
Required compressed air	8-10 Bar

- <sup>2</sup>  **The already factory-set hydraulic work pressure is adjusted to the maximum rating. The setting of the pressure control valve may not be changed. Any changes to the settings could cause serious damages.**  
**If the nominal load could be not lifted please contact our service team.**

### Loading distribution

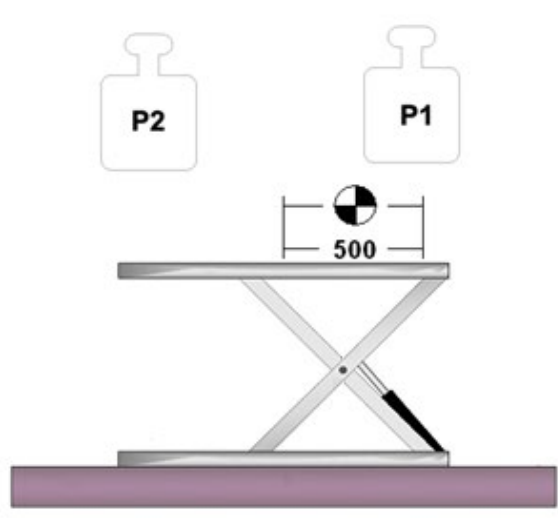
Q	Vehicle weight	
P1	Max $\frac{3}{5} \times Q$	
P2	Max $\frac{2}{5} \times Q$	
Load distribution	$\frac{3}{2}$	

## 1.5 Scale Drawing

### ATH-Bike Lift 7F:

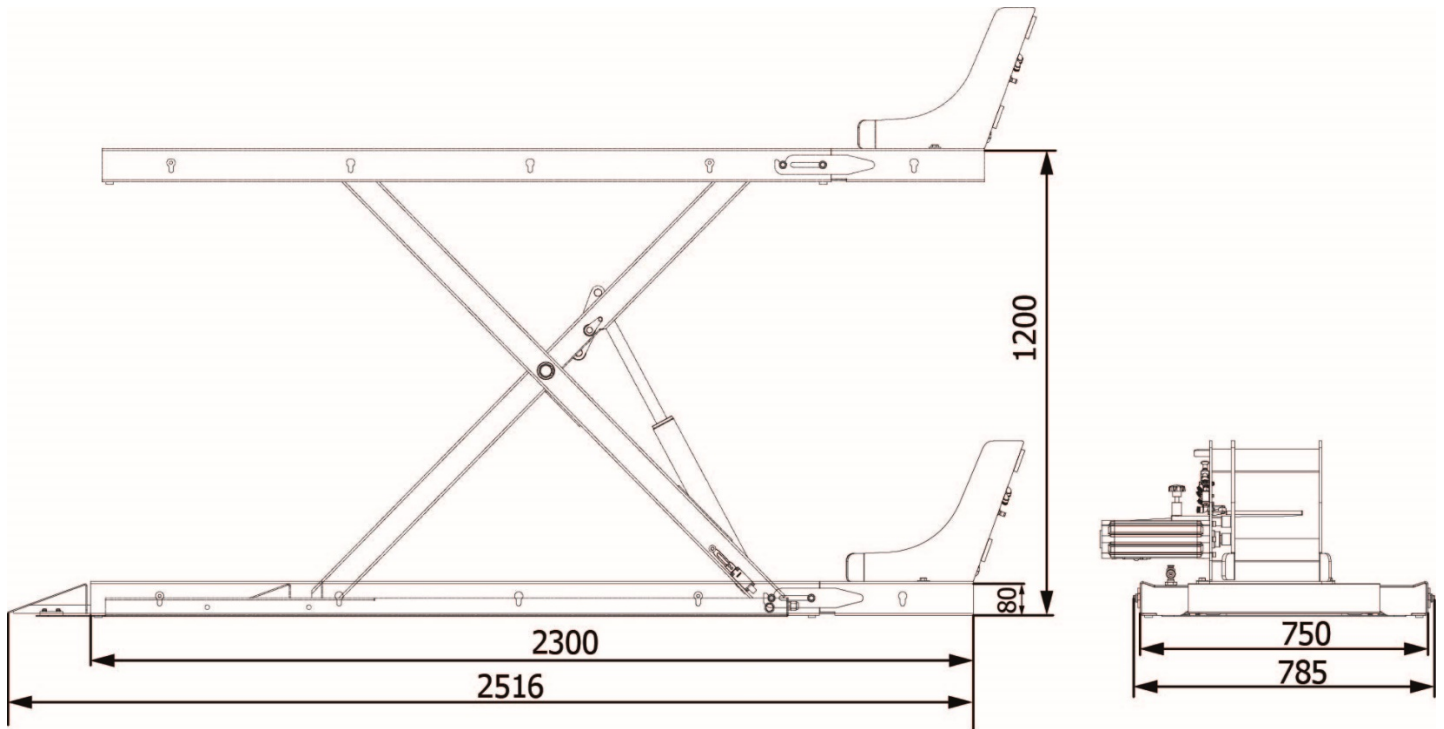

### ATH-Bike Lift 7FQ:

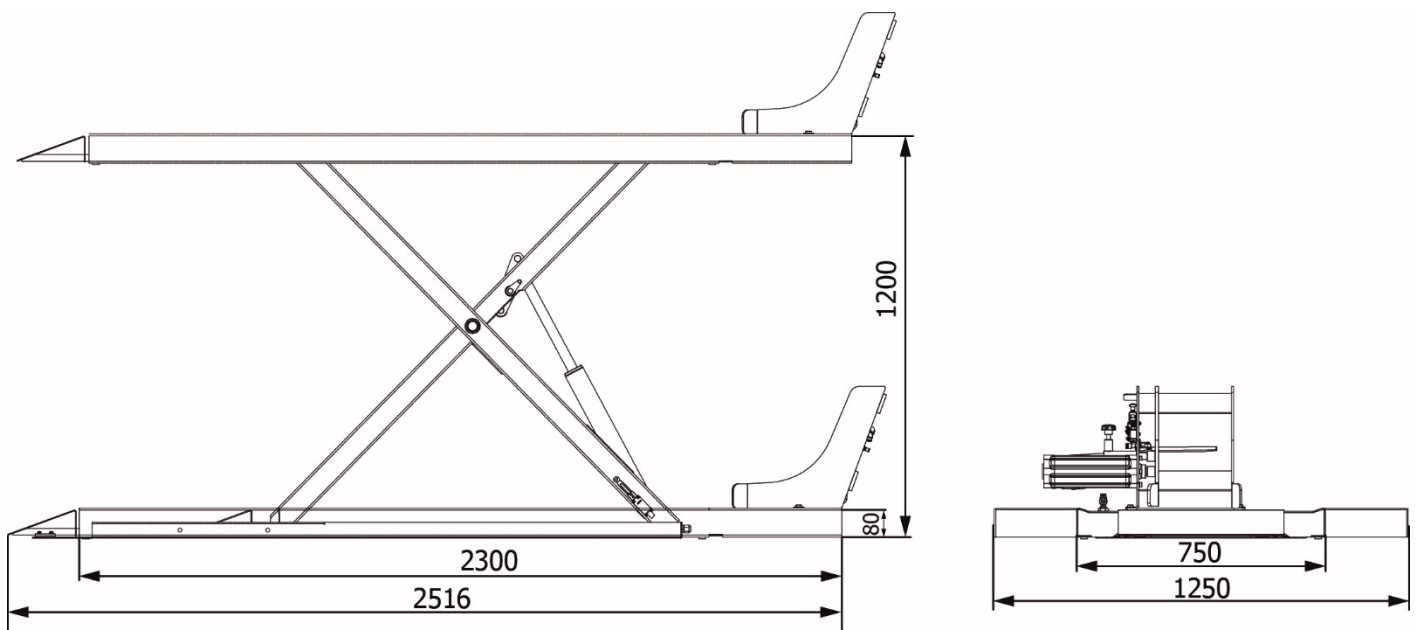

## 2.0 INSTALLATION

The machine must be installed by an authorised person according to the instructions.

	<p style="text-align: center;"><b>The operating instructions (including the log) are an important part of the machine / product. !!!PLEASE STORE CAREFULLY!!!</b></p>
---	---

The product must be checked after completion of the installation, handover, if necessary briefing and then regularly in accordance with the applicable regulations and legal provisions in the country of operation by a suitable and approved company or facility.

foundation:

Conditions:	Horizontal and flat
Concrete deep:	200 mm
Max. Slope	10 mm
Concrete quality:	C20/25
Concrete hardening time:	Min. 20 days

 If soils do not comply with the requirements, there could evoke serious injuries to personal or damages to the lift.

Do not install the lift on asphalt, soft concrete floor-

There must be no expansion joints or cuts, which will break the continuity of the upper reinforcement.

Load-capacity of false ceilings must be checked by operator.

### 2.1 Transport & Storage Conditions

When transporting and positioning the machine, always use suitable lifting and material handling equipment and consider the machine's centre of gravity.

The machine should only be transported with the original packaging.

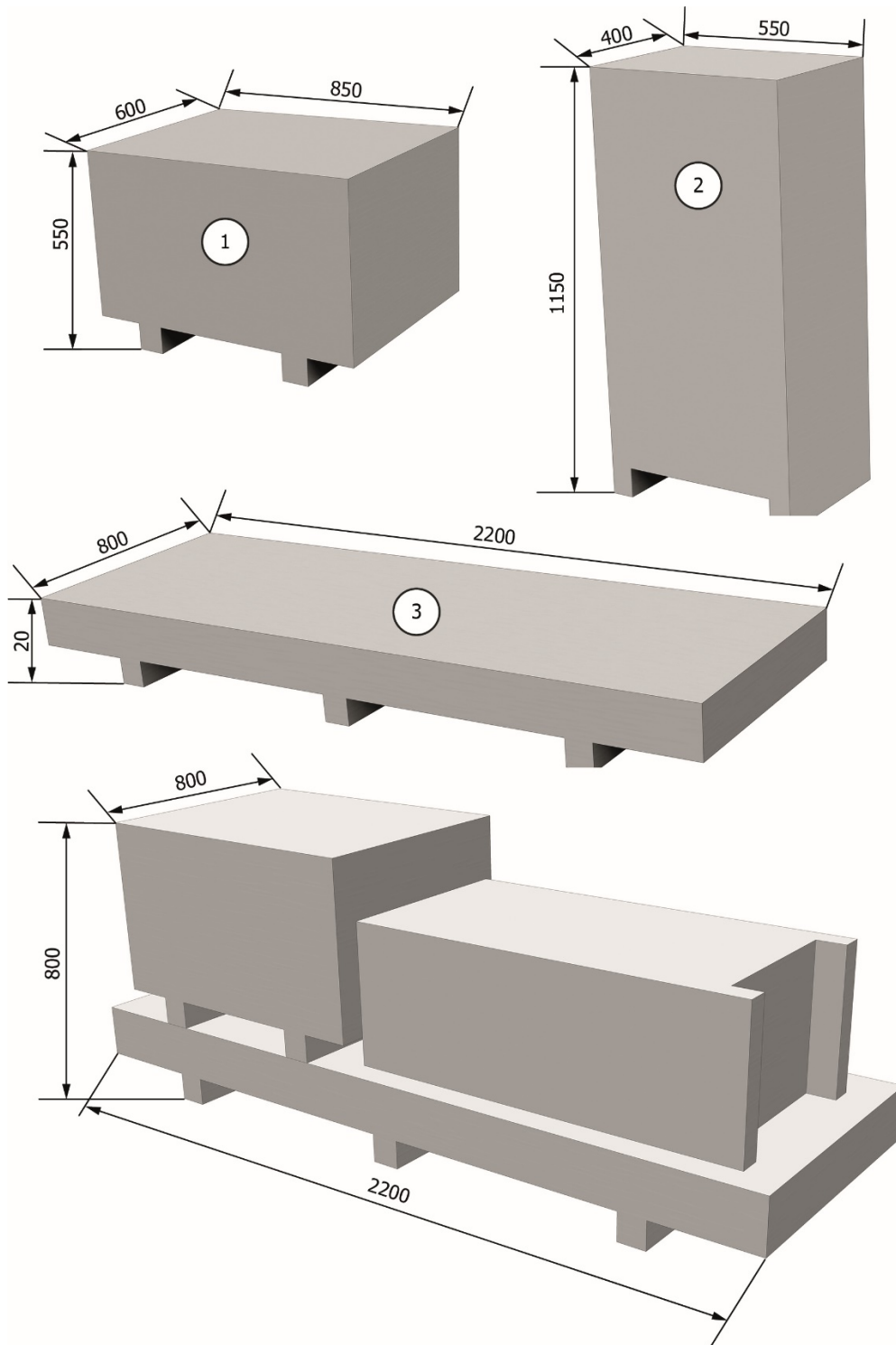

Data:	①	②	③	Complete
width	60 cm	55 cm	80 cm	80 cm
length	85 cm	115 cm	220 cm	220 cm
height	55 cm	40 cm	20 cm	80 cm
Gross weight	45 kg	56 kg	244 kg	345 kg
Storage temperature	-10 bis +50 °C			

## 2.2 Unpacking the machine



Remove the top cover of the packaging and make sure that no damage has occurred during transport.

Remove the safety bolt to remove the machine from the pallet / rack.  
Use a suitable lifting device (possibly with a stopping rope) to lower the machine from the pallet / frame.

The packaging material used for the machine should be stored carefully.  
Keep the packaging material out of the reach of children as it may be hazardous.

## 2.3 Delivery Contents

1	Basic package with: Scissor lift with already integrated hydraulic cylinders and foldable rear wheel recess  Dimension: 220cm X 80cm X 20cm Weight: 244 kg
2	Package with foldable front extension and already installed Wheel clamping device  Dimension: 85cm X 60cm X 55cm Weight: 45 kg
3	Control unit with: <ul style="list-style-type: none"> <li>• Integrated hydraulic aggregate</li> <li>• User's manual with checking book</li> </ul> Dimension: 100cm X 40cm X 40cm Weight: 56kg



If there is anything missing in the scope of delivery please contact our sales department!

### Instructions for transport and storage:

- Lift with care, support the load with means which are suitable and in good order and condition.
- Avoid sudden raisings and jerky movements. Be careful at floor unevenness, cross-drain etc.
- Store the removed packing at a collecting place until disposal, so that they are not accessible for children or animals.
- Storage temperature: -10~+40 °C



## 2.4 Location

The machine should be kept away from flammable and explosive materials, as well as from sunlight and intense light. The machine should be placed in a well-ventilated location.

The machine must be set up on sufficiently firm ground, if necessary, according to the minimum requirements of the information given in the foundation plan.

In addition to the ground conditions, the guidelines and instructions of the accident prevention regulations as well as the workplace regulations must be observed when selecting an installation site.

When assembling on floor coverings, check their load-bearing capacity. A construction expert should be consulted for inspection when mounting on floor coverings.

The machine should only be mounted and used within closed rooms. It has no corresponding safety features (e.g. IP protection, galvanised design, etc.).

Temperature	4-40 °C
Sea level	< 1500 m
Humidity	50% at 40 °C – 90% at 20 °C

### Drawing

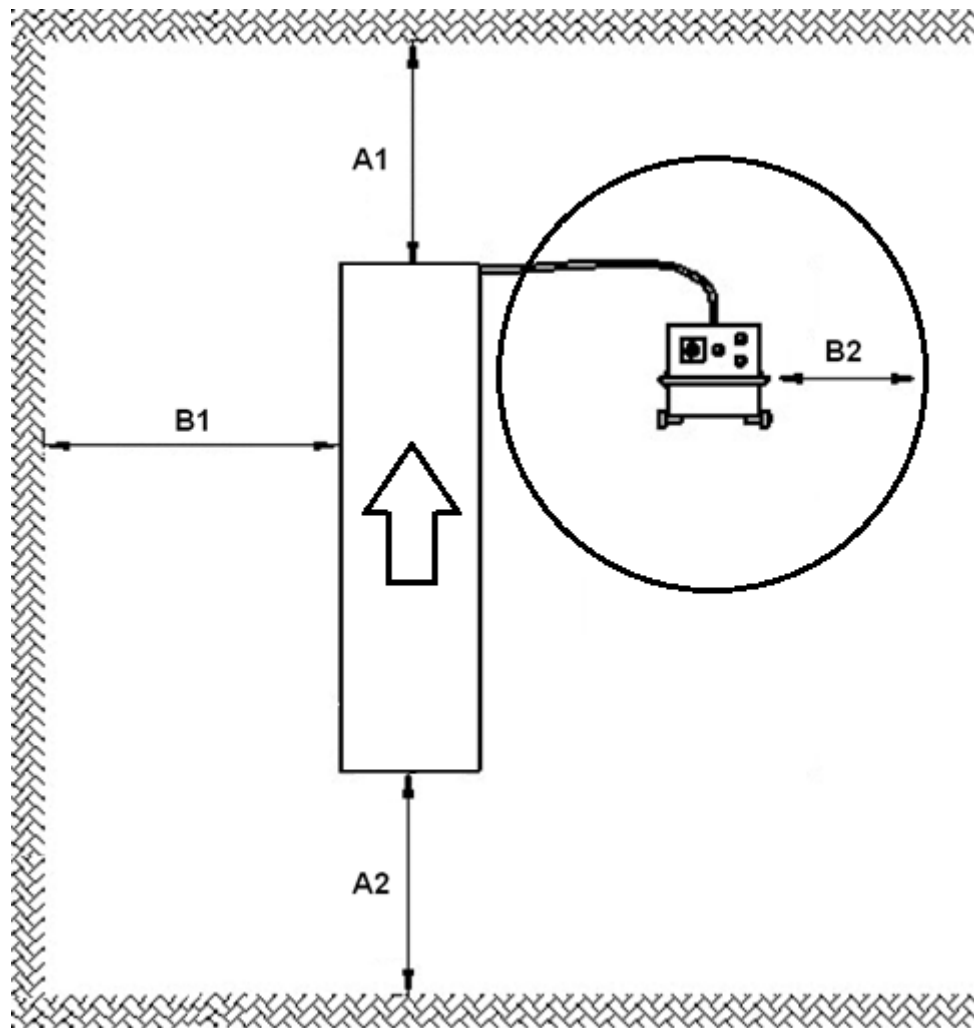

A1	Min. 700mm	A2	Min. 700 mm
B1	Min. 700 mm	B2	min. 700 mm
Power connection & earthing cable (see technical data) must be attached in the form of a plug-in device (socket and plug) or a permanent connection.			
Necessary supply line		See technical data	

 An existing escape route of at least 700 mm **must** remain, even when the vehicle is picked up.

 The installation of the lift is **not** permitted in **damp, wet** and **potentially explosive** areas.

## 2.5 Fixing



General and local regulations must be observed. Therefore, these steps should only be carried out by a trained professional.

The machine must be set up and fixed on sufficiently firm ground, if necessary, according to the minimum requirements of the information given in the foundation plan.

The machine must be fastened at the points provided with suitable or specified fastening material.

In addition to the ground conditions, the guidelines and instructions of the accident prevention regulations as well as the workplace regulations must be observed when selecting an installation site.

When assembling on floor coverings, check their load-bearing capacity. A construction expert should be consulted for inspection when mounting on floor coverings.

## 2.6 Electrical Connection



General and local regulations must be observed. Therefore, these steps may only be carried out by a trained professional.  
Pay attention to the necessary supply line (see technical data).

The connection should be made with a 230V Schuko plug or 5-phase 16 A CEE plug (partially included).

Voltage deviations should be 0.9 - 1.1 times the nominal voltage range and the frequency deviation should be 0.99 - 1.01 times the frequency range.

Necessary protective measures must be taken to guarantee this.

At the end of the work, the direction that the motor rotates must be checked.

## 2.7 Pneumatic Connection



For all pneumatic systems, a compressed air maintenance unit (partially included) must be installed between the supply line and the system.

The air pressure of the supply line must at least correspond to the technical data.

The compressed air maintenance unit must be set correctly and checked.

The compressed air maintenance unit must be serviced at regular intervals.

The maximum or minimum pressure ensures perfect functioning without any damage.

## 2.8 Hydraulic Connection



Before the system is put into operation or operated for the first time with oil, the following must be observed with regard to the optimal, trouble-free and almost air-free functioning

All hydraulic lines must be connected and tightened according to the hydraulic plan and, if applicable according to the hose designation.

All hydraulic lines and cylinders must be vented according to the hydraulic plan and, if applicable, according to the hose designation.

In order to ensure the faultless and safe functioning of the system and the hose assemblies used, the hydraulic fluids used must comply with the specific instructions and recommendations of the manufacturer.

Used media that do not meet the specific requirements or which have unauthorised contamination damage the entire hydraulic system and shorten the service life of the hydraulic systems used. Warning: (system contamination can also occur when oil is refilled)

The minimum requirement and minimum oil quantity must be checked and ensured.

## 2.9 Assembly

Assembly steps:

1. Positioning and adjustment of the lift and control box
2. Hydraulic aggregates:

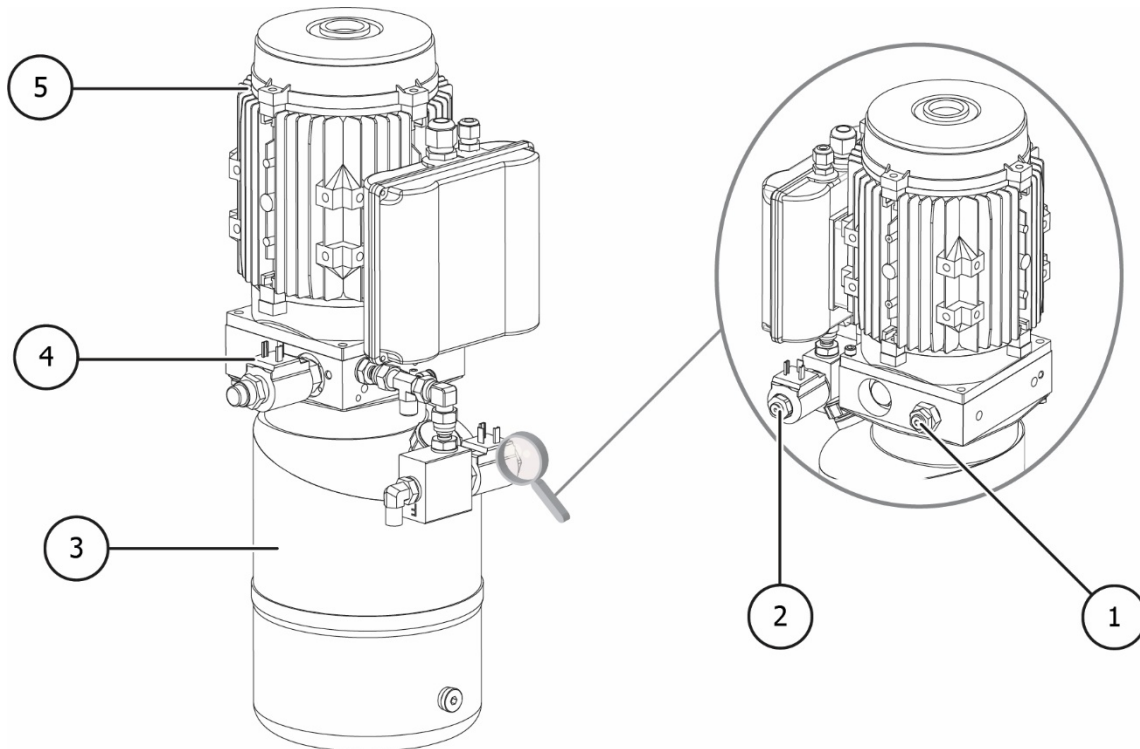

①	Pressure relief valve	④	Lowering valve
②	Control valve	⑤	engine
③	Oil tank		

### 3. Connection of hydraulic tubes

- a. Carry the hydraulic tubes through the enclosed empty tube
- b. Fix the tubes on the connections of the scissor lift and on the Y-connection on the control box.

 Retighten all hydraulic connections.

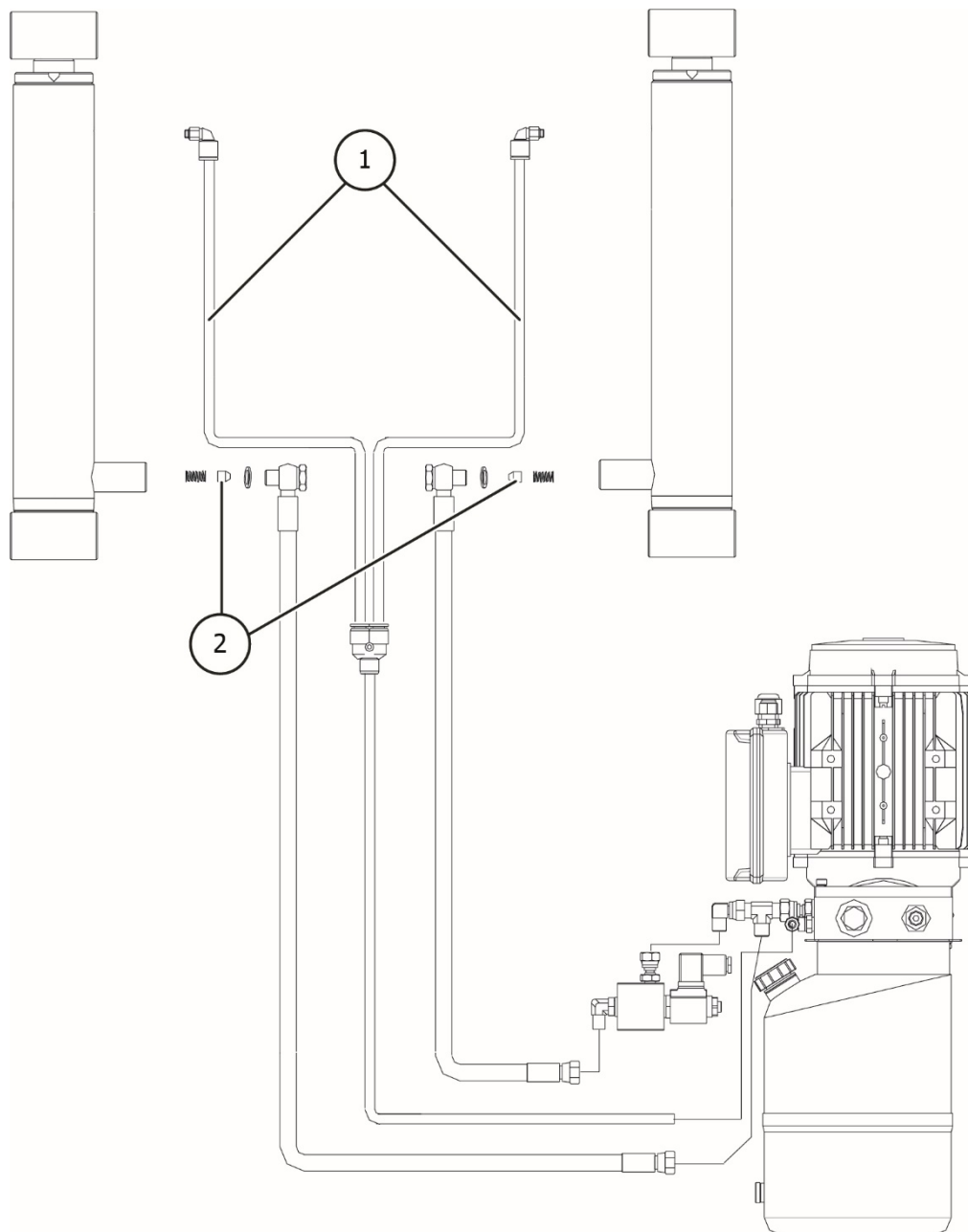

①	Oil return line
②	throttle

4. Hydraulic oil

- a. Fill in the hydraulic oil until the marking on the dipstick
- b. For venting of the hydraulic circuit leave the tank cap open for the first 10 lifting movements.

5. Electrical connection

 Hereby must be observed the general and local regulation. Therefore, this step can only be done only by trained/skilled persons/experts.  
Pay attention to the necessary supply (see technical data).

6. Install on the platform the foldable front extension with pneumatic wheel clamping.

7. Control before the first lifting

- a. all screws, nuts and so on for tightness
- b. all connections and cylinders for leaks and retighten them if necessary
- c. the oil level
- d. all electrical connections (see electric diagram) as well as the ground cable
- e. that the hydraulic system will be vented completely by lowering the lift completely and pushing for appr. 15 seconds the button lowering further.
- f. the function of the limit switch (OPT)
- g. that the sliding guides of the base frame and the platform are lubricated (see lubrication plan)

8. Lifting under load

- a. Lift a load to appr. 500 mm height
- b. Check that all the mounting points are in contact with the vehicle. If all points are in contact with the car, the stage is straight.

9. Fill in after installing the enclosed checking book.

 This information will be required in case of a possible claim.

	<p>These instructions are not to be viewed as assembly instructions; hints and tips are provided only for trained expert installers. Suitable clothing and personal protection must be worn for the following work. Incorrect installation and settings lead to exclusion of liability and warranty.</p>
--	--

Partly pre-assembled machines must be checked, introduced and approved by a competent person before commissioning.

Machine assembly must be carried out by a qualified and competent person.

## 2.10 Completion of Work



Before commissioning, check all fastening screws, electrical, pneumatic and hydraulic lines and, if necessary, tighten these. Warning: in some cases, this must be checked at regular intervals and tightened if necessary (note in the instructions).



### 3.0 OPERATION

#### 3.1 Operating Instructions

Company:	<b>Operating Instructions</b>	Date:
Place of work:	for <b>Lifting Platform</b>	Signature:

#### *Risks to People and the Environment*



- Falling of loads or parts
- Crushing and shearing points when moving the lifting platform
- Danger due to uncontrolled moving parts



#### *Protective Measures and Rules of Conduct*

##### **Before starting work:**



- Lifting platforms may only be used independently by trained persons over the age of 18 who have been instructed in writing.
- When working with more than one person, a supervisor must be appointed
- Daily functional check
- Observe the manufacturer's operating instructions

##### **During operation:**



- Pay attention to crush and shear points in the environment
- Do not load the lifting platform above the permitted maximum load
- Do not lift people
- Do not shake the lifting platform, avoid rocking.
- When lowering, do not stand in the lifting platform movement area
- Arrange regular checks of the lifting platform

#### *Response to faults and hazards*

- In case of fault, stop the lifting platform immediately
- Secure against further use
- Report defects to the installer or manufacturer

#### *First Aid*



- Inform first aiders (see alarm/emergency plan)
- Treat injuries immediately
- Enter into the accident book
- Contact emergency services for serious injuries

**Emergency number:** \_\_\_\_\_  
**Ambulance service:** \_\_\_\_\_

#### *Maintenance*

- Repair only by instructed and trained persons
- Disconnect or secure the lifting platform from the mains power supply for set-up, adjustment, maintenance or servicing
- Clean the lifting platform after operation and check the hydraulic level
- **Annual check** of the lifting platform by an authorised and trained person

### 3.2 Basic Information

Independent operation of the machine may only be carried out by persons over the age of 18 who have been trained in the operation of the machine and have demonstrated their ability to do so to the employer. They must be expressly contracted by the employer to operate the machine. The order to operate the machine must be given in writing.

The machine must only be used for its intended use.

Always use appropriate material during installation and operation.



Before assembly or disassembly check all components for damage.

If necessary, observe special manufacturer instructions for mounting or dismounting of vehicle-specific work.

An important part of the guarantee / warranty is fulfilment of the maintenance plan. This includes in particular, ensuring cleanliness, corrosion protection, checks and repairing damages immediately if required.

During operation attention should always be paid to hazards. As soon as dangers occur, switch off the machine immediately, remove the mains plug and disconnect the air supply. Then contact your dealer.



All warning labels must always be easy to read. If damaged, they must be replaced immediately.

	<p>Pay attention to possible shearing points around the machine.</p>
	<p>During operation, the noise can reach 85dB (A), so the operator should take appropriate protective measures.</p>
	<p>Moving parts of the machine can catch loose clothing, long hair or jewellery.</p>

## 4.0 MAINTENANCE

The user must maintain the machine regularly to ensure safe operation.

Repair work may only be carried out by authorised service partners or after customer consultation with the manufacturer.

	<p>Before maintenance and repair work:</p> <ul style="list-style-type: none"> <li>- The machine must be disconnected from ALL supply networks</li> <li>- Pull main switch out of mains plug, if necessary, discharge compressed air from system</li> <li>- Appropriate measures must be taken against a restart</li> </ul>
	<p>Work on electrical elements or on the supply line may only be carried out by experts or electricians.</p>

### 4.1 Consumables for installation, maintenance and servicing

#### Hydraulic Oil

**General** minimum requirement:

Eni PRECIS HVLP-D Item No. 00066018

Summer (15° to 45°): HVLP-D 46 (e.g.: Eni PRECIS HVLP-D)

Winter (under 10°): HVLP-D 32 (e.g.: Eni PRECIS HVLP-D)

Minimum requirement **especially for 2-post lifts:**

Eni PRECIS HVLP-D Item No. 00067218

Summer (15° to 45°): HVLP-D 32 (e.g.: Eni PRECIS HVLP-D)

Winter (under 10°): HVLP-D 22 (e.g.: Eni PRECIS HVLP-D)

#### Preservative for ropes, welds, screws, corners, edges and cavities.

Minimum requirement:

Petec spray translucent - 500 ml Item No. 73550 / Petec wall inlet translucent - 1000 ml Item No. 73510

Petec UBS pistol Item No. 98507

#### Slideway lubricant

Minimum requirement:

STORER WHS 2002 White EP high performance grease. Item No. KPF1-2K-20

#### Lubricant for bushes, chains, rollers & moving parts

Minimum requirement:

White ultra lube, 500 ml aerosol. Item No. 34403 – WUL – White Ultra Lube

#### Floor anchor

Minimum requirement **for lifting platforms:**

Fischer FIS A M 16 x 200 galvanised in combination with Fischer Superbond reaction cartridge

Minimum requirement for **passenger car and passenger car/truck balancing machine:**

Impact anchor M8 x 100

Minimum requirement **for truck mounting machine:**

Impact anchor M12 x 100

### **Compressed air system**

Minimum requirement:

PROMAT chemicals special compressed air oil      Item No.: 4000355209

### **Cleaning**

Minimum requirement:

Caramba intensive brake cleaner acetone-free

### **Care and protection of metals, painted or powder-coated surfaces**

Minimum requirement:

Petec spray translucent - 500 ml      Item No. 73550

Petec wall inlet translucent - 1000 ml      Item No. 73510

Petec UBS pistol      Item No. 98507

### **Care and protection of metals, painted or powder-coated surfaces in the tread area and plastic parts**

Minimum requirement:

Valet Pro Classic Protectant Plastic Sealant 500 ml

## **4.2 Safety Regulations for Oil**

Always observe the legal requirements or regulations for handling used oil.

Always dispose of used oil through a certified organisation.

In the case of leaks, oil must be collected immediately with binders or trays so that it cannot penetrate into the soil.

Avoid any skin contact with the oil.

Do not allow oil vapours to escape into the atmosphere.

Oil is a combustible medium. Pay attention to possible hazards.

Wear oil-resistant protective clothing, such as gloves, goggles, protective clothing, etc.

### 4.3 Notes

	<p>Regardless of the level of dirt, the machine must be maintained, cleaned and serviced at regular intervals.</p> <p>The machine should then be treated with a care product (such as oil or wax spray). Do not use cleaning agents that are harmful to the skin.</p> <p>IF THE ABOVEMENTIONED POINTS ARE NOT FULFILLED, THE WARRANTY CLAIM IS EXCLUDED</p>
---	---

### 4.4 Maintenance or Service Plan

Interval	Immediately	Weekly	Monthly	Every 3 months	Every 6 months
Check of ALL safety-relevant parts	X				
Cleaning	X				
Check or restore surface protection	X				
Check for leaks in the hydraulic system	X				
Check or restore surface protection or corrosion protection	X				
Check or restore damage to the paint and components	X				
Check or restore rust damage	X				
Check or treat cavities and non-painted areas	X				
Check for leaks in the pneumatic system	X				
Control the tightness of screws	X				
Check, lubricate & adjust bearing slack	X				
Check wear parts		X			
Check fluids (level, wear, contamination, quality)		X			
Check and lubricate sliding surfaces		X			
Remove any dirt inside			X		
Clean and check electrical components				X	
Check motor and transmission for function and wear				X	
Check welds and construction				X	
Visual inspection (according to inspection plan)					X

#### 4.5 Troubleshooting / Error Display and Solutions

Symptoms	Cause	Solution
<b>Lifting Problems</b>		
<b>Lifting platform does not lift when button is pressed (motor does not run)</b>	Damage to the motor	Check motor and replace if necessary
	Blown fuses from e.g. voltage fluctuations	Remedy the causes and replace the fuses
	Defective button and/or contact	Replace button and/or contact
	Defective main switch and/or contact	Replace main switch and/or contact
	Defective or insufficient supply line	Replace cable
	Fluctuating or incorrect input voltage	Check power
	Defective motor contactor	Replace motor contactor
	Thermal relay has tripped	Check thermal relay and motor
	Limit switch defective or blocked	Check limit switch and replace if necessary
<b>Lifting platform does not lift when button is pressed (motor runs)</b>	Hydraulic oil shortage	Refill oil
	Oil filter blocked	Clean the oil filter
	Oil leakage	Replacement of damaged components
	Opened lowering valve	Check and replace the lowering valve if required
	Motor rotates in wrong direction	Replace phases
	Broken gear pump	Check the pump and replace if necessary
	Permissible load has been exceeded	Work within the specified load
	Pressure relief valve set too low	Set pressure relief valve to maximum load
<b>Lifting platform lifts jerkily</b>	Not enough space between rails	Distance between rails and guide must be 1.5 - 2.5 mm
	Air in hydraulic system	Bleed the hydraulic system
	Contaminated hydraulic oil	Change the hydraulic oil
	Slideways are not lubricated	Lubricate the slideways
<b>Lifting platform continues to lift after releasing the button</b>	Defective button	Replace the defective button

<b>Lowering Problems</b>		
<b>Lifting platform does not lower</b>	Safety catches do not respond	Check cable connection Check electromagnets, replace if necessary Relieve the catches by lifting
	Defective control relay	Check control relay
	Obstruction under platform	Remove obstruction
	Hose rupture protection triggered	Lift the platform briefly and press "DOWN" again
	Lowering valve is not activated	Check electrical connection
	Defective lowering valve solenoid	Replace solenoid
	Defective lowering valve	Replace
	Valve for lowering speed set incorrectly	Set
<b>If the errors cannot be rectified, lower the lifting platform with the emergency lowering screw and contact our service team</b>		
<b>Platform lowers too slowly or jerkily</b>	Contaminated lowering valve	Clean lowering valve
	Valve for lowering speed set incorrectly	Set
<b>Lifting platform lowers by itself</b>	Leaking hydraulic connections	Retighten connections if necessary
	Leaking hydraulic lines	Replace hydraulic line
	Leaking hydraulic cylinder	Replace and clean the seals of the hydraulic system
	Dirty or defective lowering valve	Clean or replace the lowering valve
	Leaking check valve	Clean or replace
<b>Other Problems</b>		
<b>Lifting platform does not raise or lower synchronously</b>	Air in hydraulic circuit	Bleed the hydraulic circuit
	Synchronising cables not tight enough	Adjust the tension or the synchronicity
<b>Product shows (heavy) rust damage</b>	Damage or lack of corrosion protection, possibly maintenance	Remove rust, clean and restore surface.
<b>Abnormal motor volume</b>	Dirty oil filter	Clean the oil filter
	Air in hydraulic circuit	Bleed the hydraulic system
	Contaminated hydraulic oil	Change the hydraulic oil
<b>Circuit breaker has been activated</b>	Check the contact on the contactor	Replace the contactor
	Check the capacity of circuit breakers	Replace the fuses
	Check for damage to the cable	Replace the cable
<b>ALWAYS USE ORIGINAL PARTS AND ACCESSORIES.</b>		

## 4.6 Maintenance and Service Instructions



All maintenance and service work should be carried out at least according to the maintenance schedule

### COMPRESSED AIR MAINTENANCE UNIT (Partial stock if necessary for the activity)

#### SETTING THE WORKING PRESSURE:

- Check the working pressure displayed by the manometer (1). This must correspond to the technical data.
- The working pressure can be adjusted with a pressure regulator (A).
- Pull the pressure regulator upwards to make adjustments.
- Turn the knob clockwise to increase the pressure in the machine, turn it counter clockwise to decrease.

#### OILER

- Check the oil level in the oil reservoir (3).
- Remove the oil reservoir.
- Now refill the tank with a pneumatic oil with a viscosity of SAE20.
- Check the injection quantity of the oil through the viewing glass (4).
- Generally, the screw must be closed completely in a clockwise direction and then opened again about  $\frac{1}{4}$  to  $\frac{1}{2}$  turn by turning it counter clockwise.

#### WATER SEPARATOR

- Check the water level in the separator (2).
- Water is drained when the valve (B) is opened.

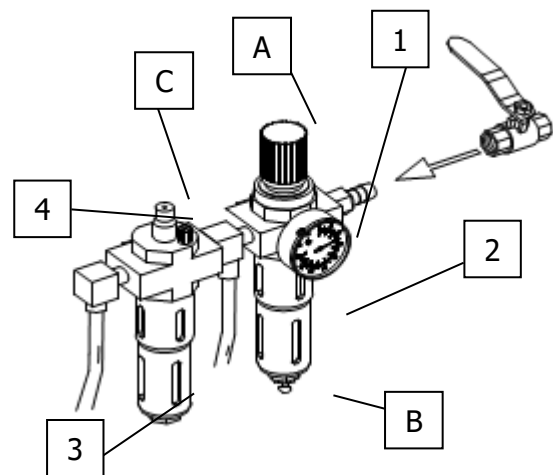



## 4.7 Disposal

- Remove the air and power supply.
- Remove all non-metallic substances and store them in accordance with local regulations.
- Remove the oil from the machine and store it in accordance with local regulations.
- Recycle all metallic substances.



The machine contains some substances that can pollute the environment and cause harm to the human body if not handled correctly.

## 5.0 EG-/EU-KONFORMITÄTSERKLÄRUNG / EC-/EU-DECLARATION OF CONFORMITY

gemäß Maschinenrichtlinie 2006/42/EG, Anhang II 1A, EMV-Richtlinie 2014/30/EU, Anh. IV  
*In accordance to Machine Directive 2006/42/EG, Appendix II 1A, EMC Directive 2014/30/EU, App. IV*

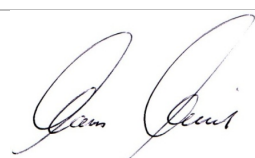
Seriennummer / <i>Serial number</i>	
<u>Firmenbezeichnung und vollständige Anschrift des Herstellers</u> <i>Business name and full address of the manufacturer</i>	<b>ATH-Heinl GmbH &amp; Co. KG</b> Gewerbepark 9 DE – 92278 Illschwang
<u>Name und Anschrift des Dokumentations-Bevollmächtigten</u> <i>Name and address of the Technical Files authorized representative</i>	<b>ATH-Heinl GmbH &amp; Co. KG</b> Gewerbepark 9 DE – 92278 Illschwang
<p>Hiermit erklären wir, dass die nachfolgend bezeichnete Maschine in der von uns in Verkehr gebrachten Ausführung den einschlägigen, grundlegenden Sicherheits- und Gesundheitsanforderungen der EG-Richtlinie 2006/42/EG sowie den unten aufgeführten Harmonisierungsrechtsvorschriften entspricht.  <i>We herewith declare that that the machine described below, as a result have been brought on to the general market comply with the relevant fundamental Safety and Health regulations of the of Directive 2000/60/EC and the harmonized standards listed below.</i></p>	
<b><u>Beschreibung der Maschine / Descriptions of the machine</u></b>	<b>Hebebühne für Fahrzeuge / Car lift</b>
Typbezeichnung / Model name	ATH-Bike lift 7F
<u>Der oben beschriebene Gegenstand der Erklärung erfüllt die folgenden einschlägigen Harmonisierungs-rechtsvorschriften der Union</u> <i>The object of the declaration described above meets the following applicable Community harmonisation legislation</i>	Richtlinie 2006/42/EG, EU-Abl. L157/24 vom 09.06.2006 Richtlinie 2014/30/EU, EU-Abl. L 96/79 vom 29.03.2014
<u>Folgende harmonisierten Normen und Vorschriften wurden eingehalten</u> <i>The following harmonized standards and regulations are applied</i>	DIN EN 1493:2010 (Machine-Directive) DIN EN 60204-1: 2006+A1:2009 (Low voltage directive)
Prüfinstitut <i>Institute of Quality</i>	CCQS UK Ltd., 5 Harbour Exchange Square London, E14 9GE, United Kingdom
Referenznummer der technischen Daten <i>Reference number for the technical data</i>	TF-0514-19-73-04-5A
Nummer des Zertifikats <i>Number of the certificate</i>	CE-C-0514-19-73-04-5A (Machine-Directive)
<b>ATH-Heinl GmbH &amp; Co. KG</b> Gewerbepark 9 DE – 92278 Illschwang December 2017	 Hans Heinl (Geschäftsführer / General Manager)
<p><b>DURCH UMBAUTEN UND/ODER VERÄNDERUNGEN AN DER MASCHINE WIRD DIE CE-PRÜFUNG AUSSER KRAFT GESETZT UND EINE HAFTUNG AUSGESCHLOSSEN.</b>  <b>BY MODIFICATION AND / OR CHANGES TO THE MACHINE, THE CE EXAMINATION IS EXCLUDED WITHOUT LIMITATION AND A LIABILITY SHALL BE EXCLUDED.</b></p>	

## 6.0 APPENDIX

### 6.1 Pneumatic circuit diagram

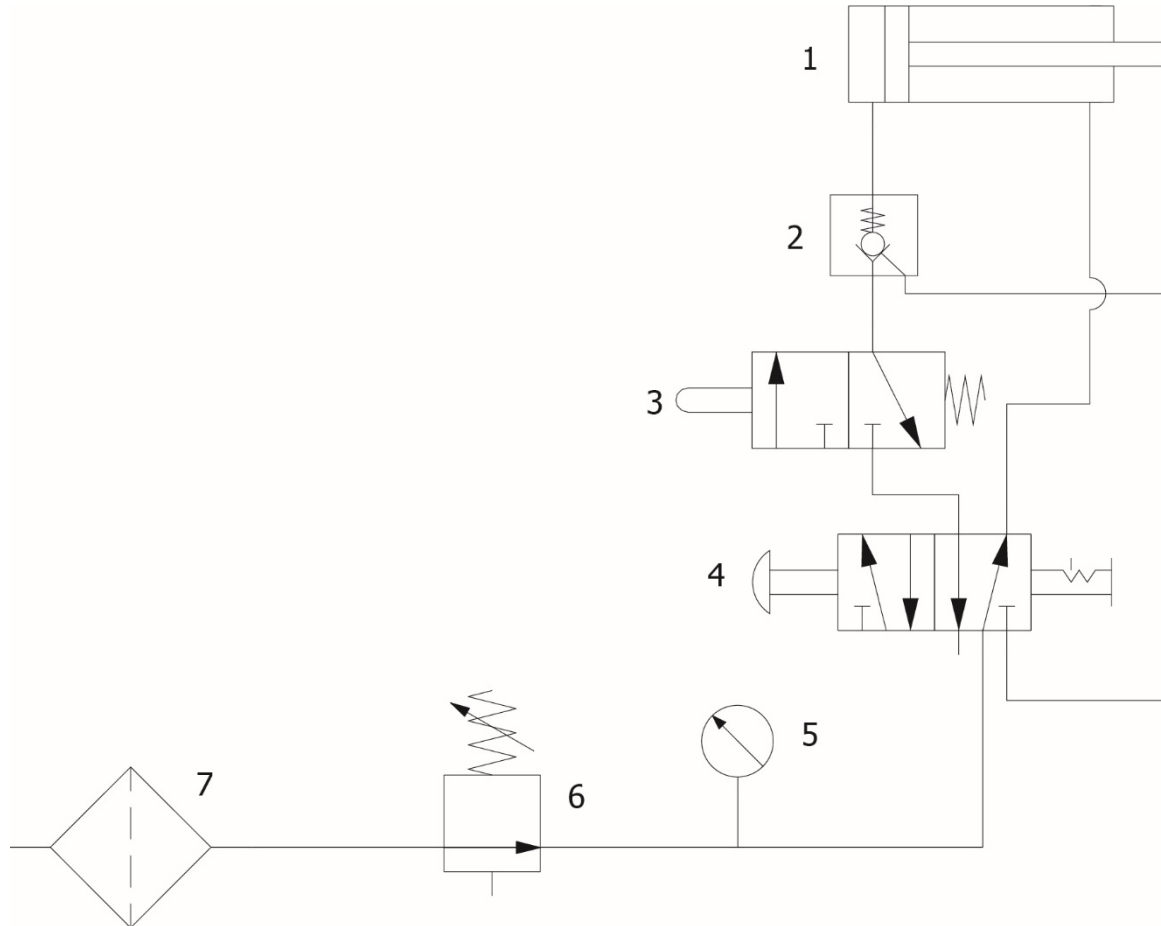

1	Pneumatic cylinder	5	Manometer OPT
2	Pneumatic non return valve	6	Pneumatic pressure settling valve OPT
3	Mechanical 3/2-ways operated valve with integrated vent connection	7	Air filter OPT
4	5/2-ways hand air operated valve		

## 6.2 Electric circuit diagram

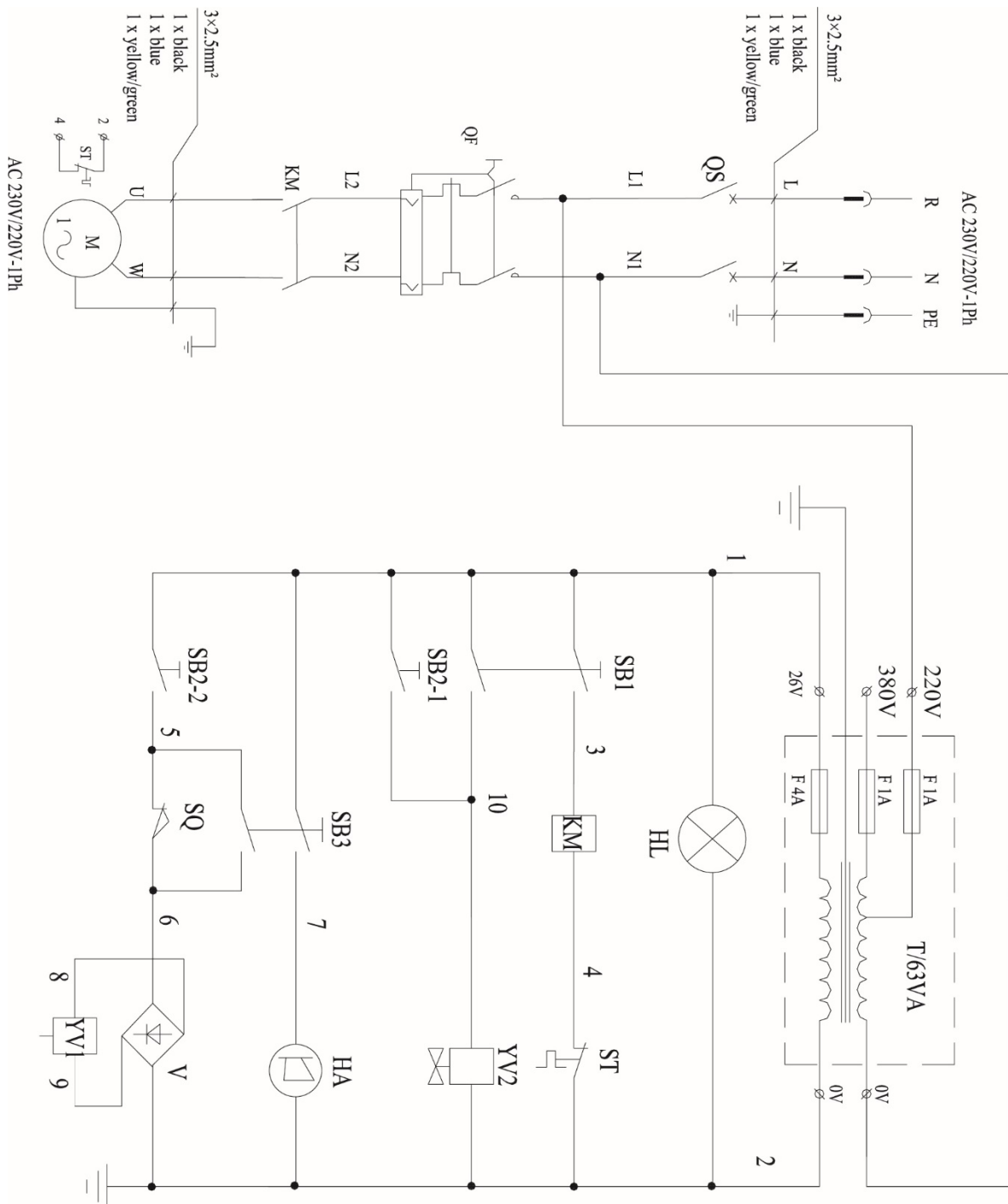

QS	Power switch	ST	Thermal relay	SB3	Final lowering button
QF	Breaker	T	Transformer 63VA	SQ	Safety height limit switch
KM	Contactor AC	SB1	Lifting button	YV	Lowering solenoid valve
M	Motor	SB2	Lowering button	YV2	Solenoid valve
HL	Signal lamp	HA	Beeper	V	Rectifier

### 6.3 Hydraulic circuit diagram

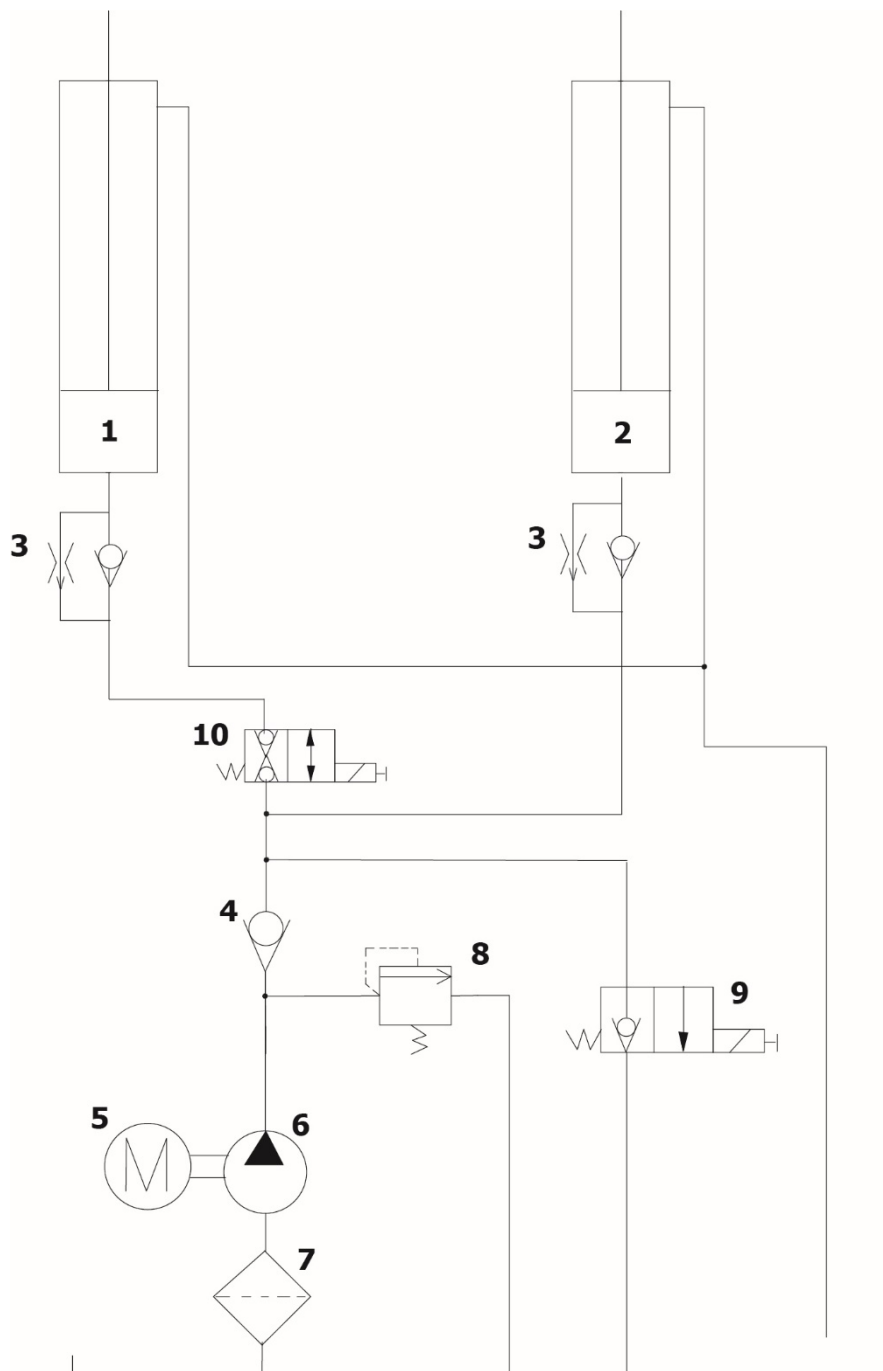

<b>1</b>	Hydraulic cylinder	<b>6</b>	Gear pump
<b>2</b>	Hydraulic cylinder	<b>7</b>	Oil filter
<b>3</b>	Flow restrictor	<b>8</b>	Pressure overload valve
<b>4</b>	Non return valve	<b>9</b>	Lowering solenoid valve
<b>5</b>	Motor	<b>10</b>	Solenoid valve

## 7.0 WARRANTY CARD

Dealer address:	Customer address:		
Company (or customer number):	Company (or customer number):		
Contact partner:	Contact partner:		
Street:	Street:		
Postcode & town:	Postcode & town:		
Tel. & Fax:	Tel. & Fax:		
Email:	Email:		
Manufacturer & model:	Serial number:	Year of construction:	Reference number:
Message description:			

Description of required spare parts:		
Spare part:	Item number:	Amount:

### IMPORTANT:

Damage resulting from improper handling, lack of maintenance or mechanical damage is not covered by the warranty. For systems that have not been installed by an ATH approved installer, the warranty is limited to the provision of the necessary spare parts.

### Transport damages:

Visible defect (visible transport damage, note on freight forwarder delivery note, immediately send copy of the delivery note and photos to ATH-Heinl)

Hidden defect (transport damage is only detected when unpacking the goods, send damage report with pictures to ATH-Heinl within 24 hours)

Place & Date

Signature & Stamp

## 7.1 Scope of the Product Warranty

- Five years for the devices structure
- Power supplies, hydraulic cylinders and all other wear components such as turntables, rubber plates, ropes, chains, valves, switches, etc., are limited to one year under normal circumstances/use under warranty conditions.

The warranty does not extend to:

- Defects caused by normal wear and tear, misuse, transport damage, improper installation, tension or lack of required maintenance.
- Damage caused by neglect or failure to follow the instructions in this manual and/or other accompanying instructions.
- Normal wear and tear on parts requiring service to keep the product in safe working condition.
- Any component that has been damaged during transport.
- Other components that have not been explicitly listed but are considered to be general consumables.
- Water damage caused by e.g. rain, excessive humidity, corrosive environments or other contaminants.
- Blemishes that do not affect function.

**WARRANTY IS NOT VALID,  
IF THE WARRANTY CARD WAS NOT SENT TO ATH-HEINL.**

Damage and malfunctions caused by non-compliance with maintenance and adjustment work (according to operating instructions and/or training), faulty electrical connections (rotating field, rated voltage, protection) or improper use (overload, outdoor installation, technical changes) are excluded from the warranty!

## 8.0 INSPECTION LOG

	<p><b>This inspection manual (including log) is an important part of the operating instructions and product.</b></p> <p><b>!!!PLEASE STORE CAREFULLY!!!</b></p>
---	---

### Check

The product must be checked after completion of the installation, handover, if necessary briefing and then regularly in accordance with the applicable regulations and legal provisions in the country of operation by a suitable and approved company or facility.

In the case of changes or extensions to the product type, an additional inspection book must be maintained and accepted.

### Scope of Inspection



In addition to perfect function, cleanliness and maintenance requirements, it is vital that the safety-relevant components of the entire system are checked.

### Technical Data

- Please refer to the enclosed operating instructions.

### Nameplate

- Make a note of all the data below
- Manufacturer & type of mounting materials used:

 <b>ATH-Heinl</b>	
<b>Typ</b> Type	<b>Volt</b>
<b>Serien #</b> Serial #	<b>Ph</b>
<b>Baujahr</b> Year of built	<b>Hz</b>
	<b>Amp.</b>
	<b>kW</b>
 	Designed by ATH-Heinl Germany Manufactured in China  ATH-Heinl GmbH & Co. KG Gewerbepark 9 D 92278 Illschwang Germany



## 8.1 Installation and Handover Log

**Site:**

Company:  
Street:  
Town:  
Country:

**Device / system:**

Manufacturer:  
Type / model:  
Serial no.:  
Year of  
construction:

Responsible retailer:

The above product has been assembled, checked for function and safety and put into operation. Installation was carried out by:

the operator

the technical expert

The operator confirms that the product type has been set up correctly, that he/she has read and understood all information contained in these operating instructions and the log, and that he/she keeps this documentation accessible to the instructed operator at all times.

The operator confirms that after installation and commissioning by a person trained by the manufacturer or an authorised dealer (expert), instruction in the function, handling, safety-relevant specifications, maintenance and care of the machine has taken place, documents, information and specifications of the machine have been provided and the product is working properly.

**IMPORTANT NOTES:**

**IF THE ABOVEMENTIONED POINTS ARE NOT FULFILLED, THE WARRANTY CLAIM IS EXCLUDED:**

The warranty is only valid in conjunction with compliance and evidence of proper assembly, handover, and if necessary training, as well as yearly maintenance carried out by an expert authorised by the manufacturer. The interval between services must not exceed 12 months. In case of non-standard use or multi-shift or seasonal use, a bi-annual inspection and maintenance must be arranged.

Warranty claims are only recognised if all points in the log and operating instructions have been met, the claim is asserted immediately after detection and **this log is sent to the manufacturer along with the maintenance and service logs.**

Further specific information about the warranty, such as scope, requirements and specifications, are described in the operating instructions and must be observed.

Damages and complaints caused by improper handling; failure to maintain and service; use of unsuitable or unspecified assembly, operating, maintenance or service products; mechanical damage; intervening in the unit without consultation or by an unauthorised expert are excluded from the warranty. For systems that have not been installed by an authorised expert, the warranty is limited by agreement of the manufacturer to the provision of the necessary spare parts.

---

Expert name and company stamp  
if necessary, number and name of retailer

Date and expert signature

---

Operator name and company stamp

Date and operator signature

## 8.2 Inspection Plan

Nameplate				
Quick reference guide				
Operating instructions				
Safety label				
Operation label				
Other labels				
Construction (deformation, cracks)				
Fixing dowels and stability				
Condition of concrete floor (cracks)				
Condition / general condition				
Condition / cleanliness				
Condition / care and sealing				
Condition / liquids				
Condition / lubrication				
Condition / aggregate				
Condition / drive				
Condition / motor				
Condition / transmission				
Condition / cylinder				
Condition / valve				
Condition / electrical control				
Condition / electric buttons				
Condition / electric switches				
Condition / electric lines				
Condition / hydraulic lines				
Condition / hydraulic screws				
Condition / pneumatic lines				
Condition / pneumatic screws				
Condition / tightness				
Condition / bolts and bearings				
Condition / consumables				
Condition / covers				
Condition / functions under load				
Condition / safety-relevant components				
Condition / electrical safety device				
Condition / hydraulic safety device				
Condition / pneumatic safety device				
Condition / mechanical safety device				
Condition / functions under load				
Inspection sticker issued				

**8.3 Visual inspection (authorised expert)**

**Inspection Certificate**  
relating to a regular / extraordinary inspection / audit \*)

The device has undergone a readiness test.  
No / the following \*) defects were found:

---

---

---

---

---

---

Inspection contents: functional and visual inspection according to specifications  
Pending partial inspection:

---

---

There were no \*) concerns arising from commissioning, an audit is not \*) required.

---

\_\_\_\_\_  
(Place, date)

\_\_\_\_\_  
(Technical expert signature)

**Confirmation of acceptance:**

\_\_\_\_\_  
(Name of technical expert)

\_\_\_\_\_  
(Title)

\_\_\_\_\_  
(Address)

\_\_\_\_\_  
(Employed at)

\_\_\_\_\_  
Operator (company stamp, date, signature)

Faults noted \*\*) \_\_\_\_\_

Faults remedied \*\*) \_\_\_\_\_

\*) Delete if not applicable  
\*\*) Confirmation of operator or a representative with date and signature

Visual inspection (authorised expert)

## Inspection Certificate

**relating to a regular / extraordinary inspection / audit \*)**

The device has undergone a readiness test.  
No / the following \*) defects were found:

---



---



---



---



---

Inspection contents: functional and visual inspection according to specifications  
Pending partial inspection:

---



---

There were no \*) concerns arising from commissioning, an audit is not \*) required.

---

\_\_\_\_\_  
(Place, date)

\_\_\_\_\_  
(Technical expert signature)

**Confirmation of acceptance:**

\_\_\_\_\_  
(Name of technical expert)

\_\_\_\_\_  
(Title)

\_\_\_\_\_  
(Address)

\_\_\_\_\_  
(Employed at)

\_\_\_\_\_  
Operator (company stamp, date, signature)

Faults noted \*\*) \_\_\_\_\_

Faults remedied \*\*) \_\_\_\_\_

\*) Delete if not applicable  
\*\*) Confirmation of operator or a representative with date and signature

Visual inspection (authorised expert)

## Inspection Certificate

relating to a regular / extraordinary inspection / audit \*)

The device has undergone a readiness test.  
No / the following \*) defects were found:

---

---

---

---

---

Inspection contents: functional and visual inspection according to specifications  
Pending partial inspection:

---

---

There were no \*) concerns arising from commissioning, an audit is not \*) required.

---

\_\_\_\_\_  
(Place, date)

\_\_\_\_\_  
(Technical expert signature)

**Confirmation of acceptance:**

\_\_\_\_\_  
(Name of technical expert)

\_\_\_\_\_  
(Title)

\_\_\_\_\_  
(Address)

\_\_\_\_\_  
(Employed at)

\_\_\_\_\_  
Operator (company stamp, date, signature)

Faults noted \*\*) \_\_\_\_\_

Faults remedied \*\*) \_\_\_\_\_

\*) Delete if not applicable  
\*\*) Confirmation of operator or a representative with date and signature

Visual inspection (authorised expert)

## **Inspection Certificate** relating to a regular / extraordinary inspection / audit \*)

The device has undergone a readiness test.  
No / the following \*) defects were found:

---

---

---

---

---

Inspection contents: functional and visual inspection according to specifications  
Pending partial inspection:

---

---

There were no \*) concerns arising from commissioning, an audit is not \*) required.

---

\_\_\_\_\_  
(Place, date)

\_\_\_\_\_  
(Technical expert signature)

### **Confirmation of acceptance:**

\_\_\_\_\_  
(Name of technical expert)

\_\_\_\_\_  
(Title)

\_\_\_\_\_  
(Address)

\_\_\_\_\_  
(Employed at)

\_\_\_\_\_  
Operator (company stamp, date, signature)

Faults noted \*\*) \_\_\_\_\_

Faults remedied \*\*) \_\_\_\_\_

\*) Delete if not applicable  
\*\*) Confirmation of operator or a representative with date and signature

